

HAMILTON HIGHWAY

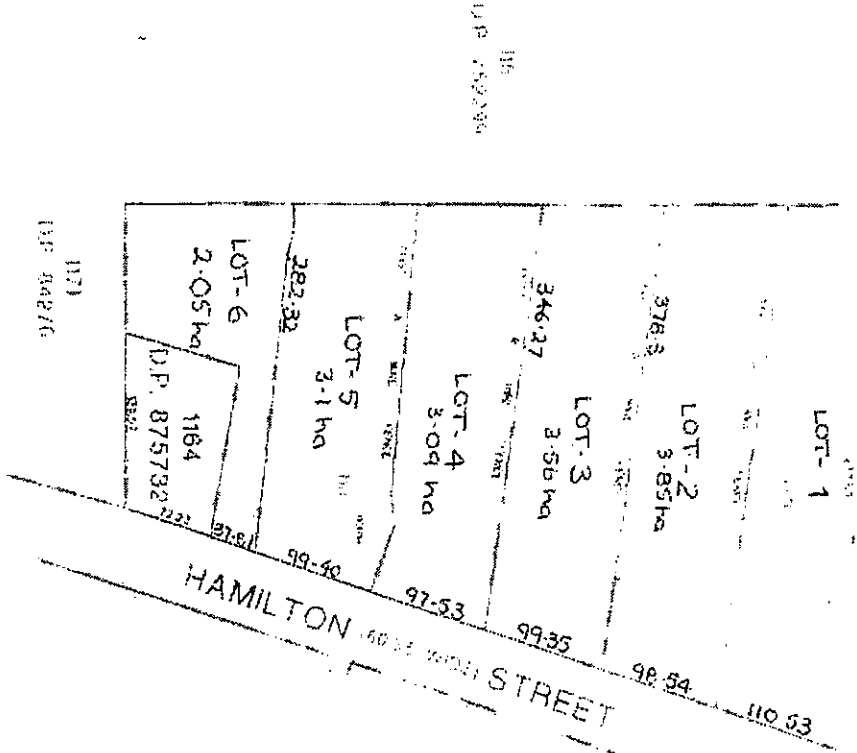

HAMILTON STREET

AMENDED
21/10/2014

IMPORTANT NOTE:
THIS PLAN HAS BEEN PREPARED BY THE CONSULTING ENGINEER IN ACCORDANCE WITH THE REQUIREMENTS OF THE ENGINEERING ACT AND THE ENGINEERING REGULATIONS. THE ENGINEER HAS CONDUCTED A VISUAL INSPECTION OF THE SITE AND HAS FOUND THAT THE INFORMATION PROVIDED IN THIS PLAN IS TRUE AND CORRECT TO THE BEST OF HIS KNOWLEDGE AND BELIEF. THE ENGINEER HAS NOT CONDUCTED A SURVEY OF THE SITE AND HAS NOT VERIFIED THE DIMENSIONS OF THE LOTS. THE ENGINEER HAS NOT CONDUCTED A SURVEY OF THE SITE AND HAS NOT VERIFIED THE DIMENSIONS OF THE LOTS. THE ENGINEER HAS NOT CONDUCTED A SURVEY OF THE SITE AND HAS NOT VERIFIED THE DIMENSIONS OF THE LOTS.

PROPOSED SUBDIVISION

CHRISTELLE PEARSE

Lot 1164, U.P. 875732
CANTON OF DEEPEN, COUNTY OF DENISON

NO.	SECTION	AREA (HA)	AREA (ACRES)	PERCENTAGE OF TOTAL AREA
1	LOT-1	3.85	9.45	15.6
2	LOT-2	3.85	9.45	15.6
3	LOT-3	3.56	8.78	14.5
4	LOT-4	3.09	7.63	12.6
5	LOT-5	3.1	7.65	12.6
6	LOT-6	2.05	5.06	8.1
TOTAL		24.50	60.57	100.0